

45mm BEADED DOOR

Max Doors - 1 - 1

45mm Beaded Commercial Door



FEATURES

- Single or Double Glazed
- Optional "Front bead" arrangement, no ledge to trap fingers, especially on sliding doors.
- Comprehensive range of door and track configurations
 - o Hinged doors
 - o Pivot doors
 - o Bottom Track and Overhead Sliding doors
 - o Multi Track options
- 45mm thick door leaf
- Optional Rails
- Door systems integrate with all Ai Architectural systems
- 129mm midrail options
- Accepts 6mm to 18mm single glazed
- Accepts 24 - 34mm IGU's including blinds
- Adaptable to fixed Louvres

FABRICATION:

- Square cut manufacture
- Simple panelized assembly

PRODUCT APPLICATIONS:

- Commercial entrances
- High end residential applications
- Apartments



45mm BEADED DOOR
Max Doors - 1 - 2
Extrusion ID

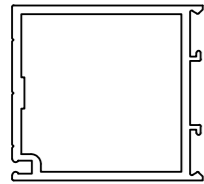

C046
Lock Stile

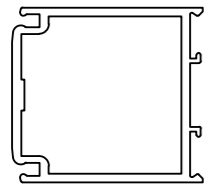

C047
Pivot Stile

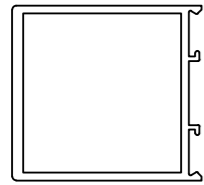

C048
Plain Stile

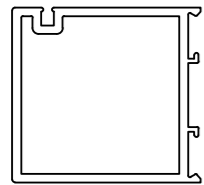

C049
Wiper Stile

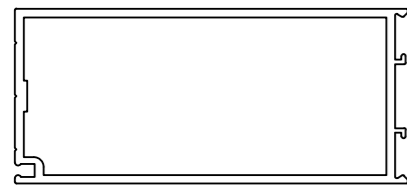

C055
Wide Lock Stile

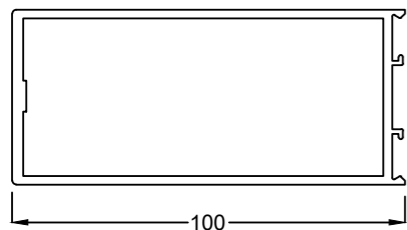

C056
Wide Plain Stile

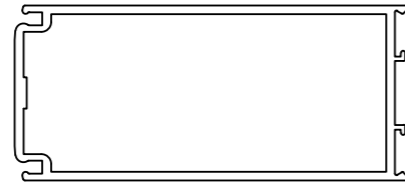

C057
Wide Pivot Stile



C058
Wide Wiper Stile

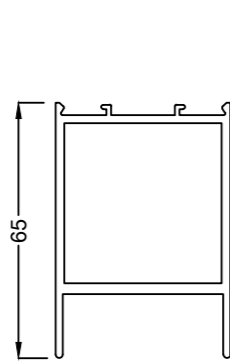

C051
Top Rail

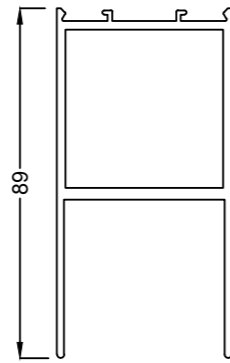

C052
Bottom Rail

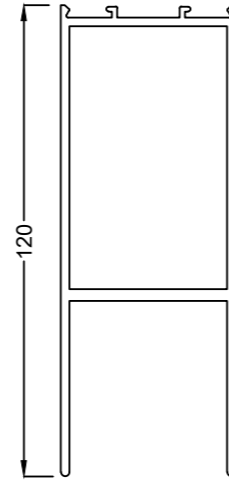

C053
Deep Rail



C050
Single Glazed Bead



C054
Tall Bead

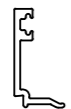

C061
Double Glazed Bead



C22976
Front Glazed
External Bead



C22975
Front Glazed
Internal Bead

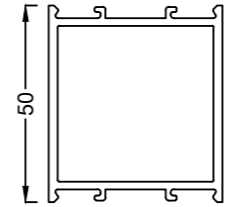

C4057EN
M50 Midrail

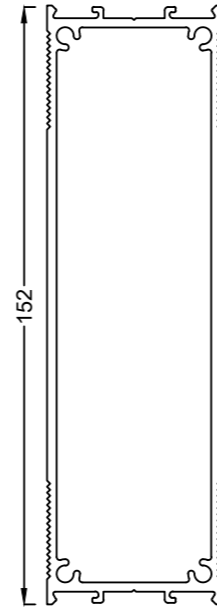

C3619EN
M150 Midrail

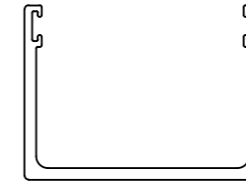

C3270
Door Channel 60 x 44.4mm

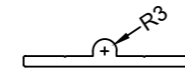

C21018
Plant on Track



C455
Meeting Stile Adaptor

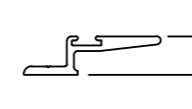

C3144
Plant on Interlock

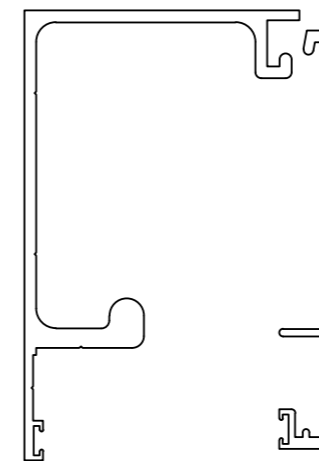

C453
Top Hung Track

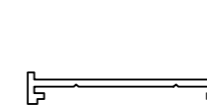

CL2080
Louvre Frame



C9384
Plant on Track

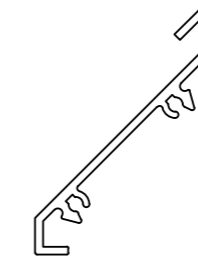

CL1592
63mm Louvre



C454
Track Pelmet

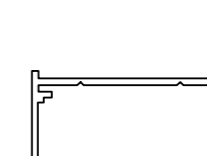

CL19408
Flanged Louvre Frame

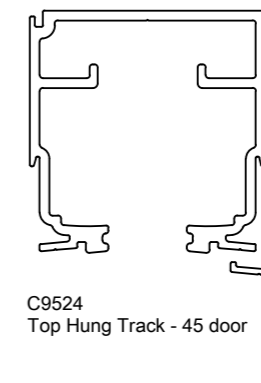

C9524
Top Hung Track - 45 door

C9388
Track Cover

45mm BEADED DOOR
Max Doors - 1 - 3
Component ID

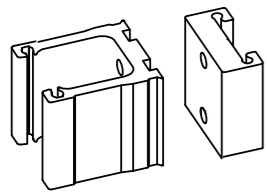

CH2
Door Spigot Set (pkg 4)

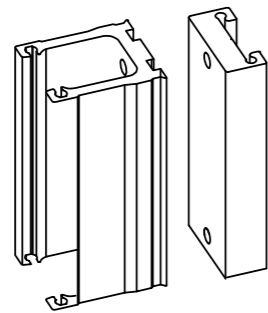

CH2W
Door Spigot Set (pkg 4)
Suits Deep Rail



CHPLUG10
10mm dia Hole Plug

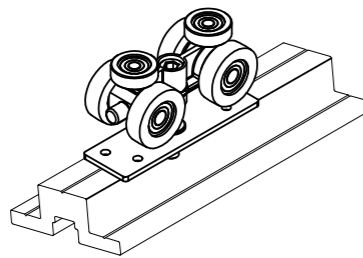

CH9591
Tommaslide roller assembly incl
Bracket & Locknut
300kg

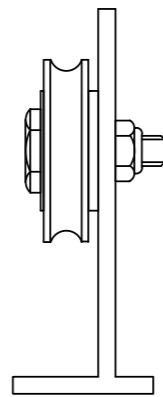

CH10
Top roller Assembly
250kg



CH9500
3mm wedge PVC



CH9501
4mm wedge PVC



CH9502
5mm wedge PVC



CH9503
7mm wedge PVC



PB 48-450-3P
4.8 x 4.5mm
Weatherpile



PB 48-500-3P
4.8 x 5.0mm
Weatherpile



PB 48450-FP
4.8 x 5.0mm
Finseal



PB 48525-3P
4.8 x 5.25mm
Weatherpile



PB 69450-FP
6.9 x 4.5mm
Finseal



PB 69550-4P
6.9 x 5.5mm
Weatherpile



PB 69550-FP
6.9 x 5.5mm
Fin Seal



PB 69800-4P
6.9 x 8mm
Weatherpile



PS11 Door Seal
Weatherpile

Door Stile Options

Narrow stiles accept Lockwood
3540 or 3580 / 3P80 Series narrow mortice locks.

3580 Series used when self latching with lever handles

3541 or 3542 Series used when self closing (on overhead closer) but non-latching on hinged and pivot doors. Typically this is used in conjunction with push / pull handles

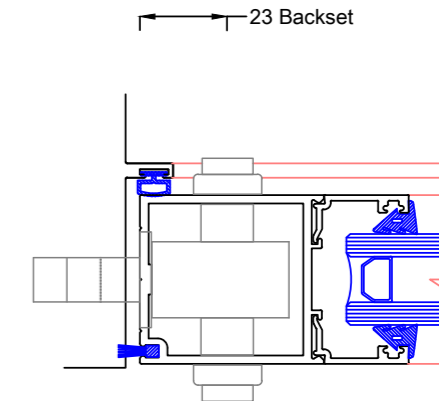
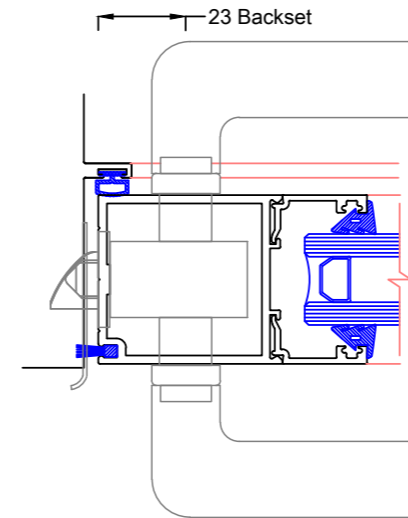

3570 Series with 60mm backset used with wide stiles when self latching hinged doors with lever handles

3574 Series with 60mm backset used with wide stiles and overhead closer on hinged and pivot doors. Typically this is used in conjunction with push / pull handles

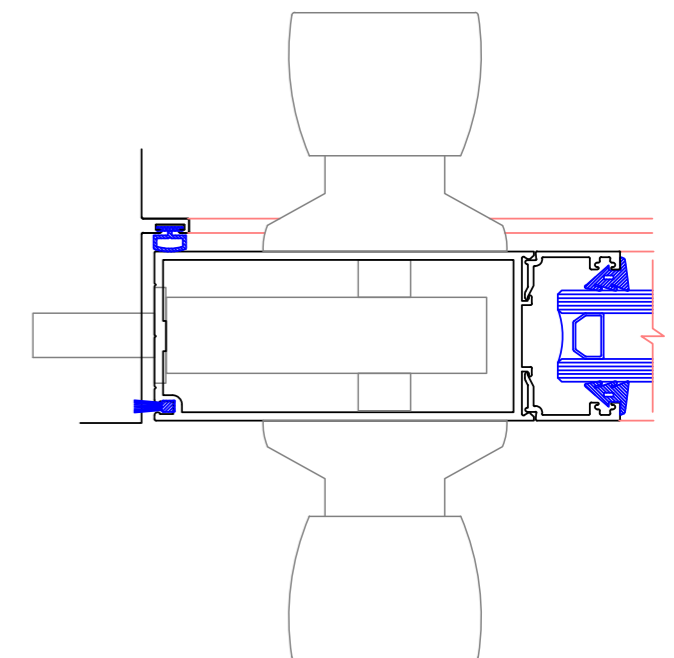
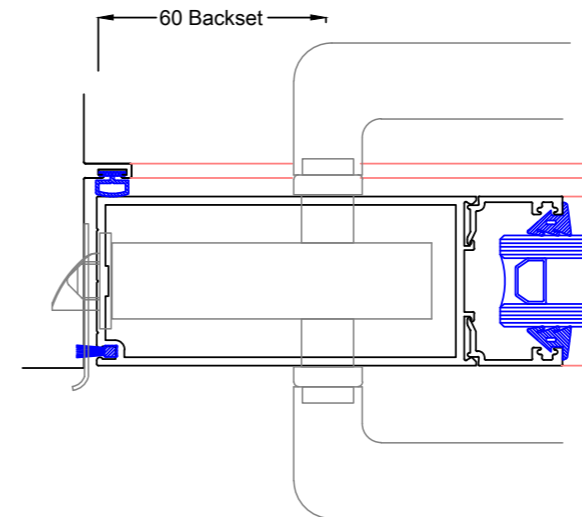

45mm BEADED DOOR
Max Doors - 1 - 4
Open Out Door

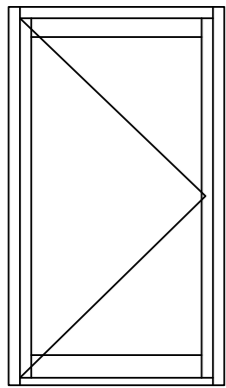

Note:
Maximum Door height 2700mm
Maximum Panel width 1000mm

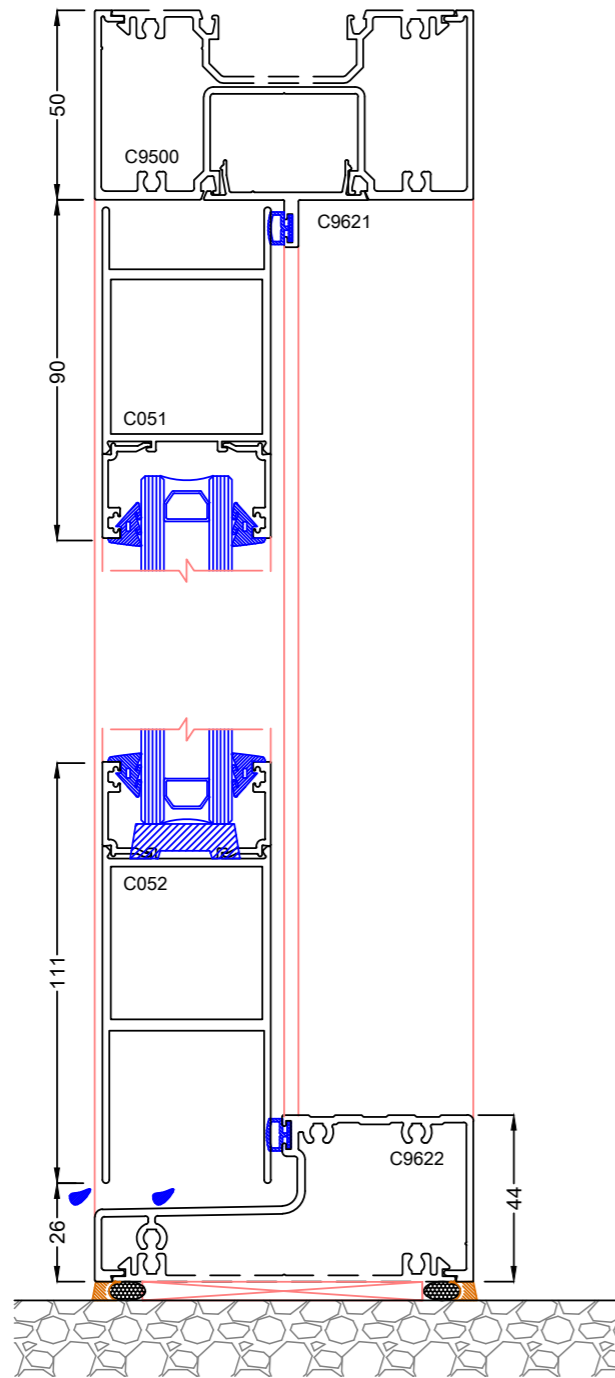

Left Hand Open Out Door

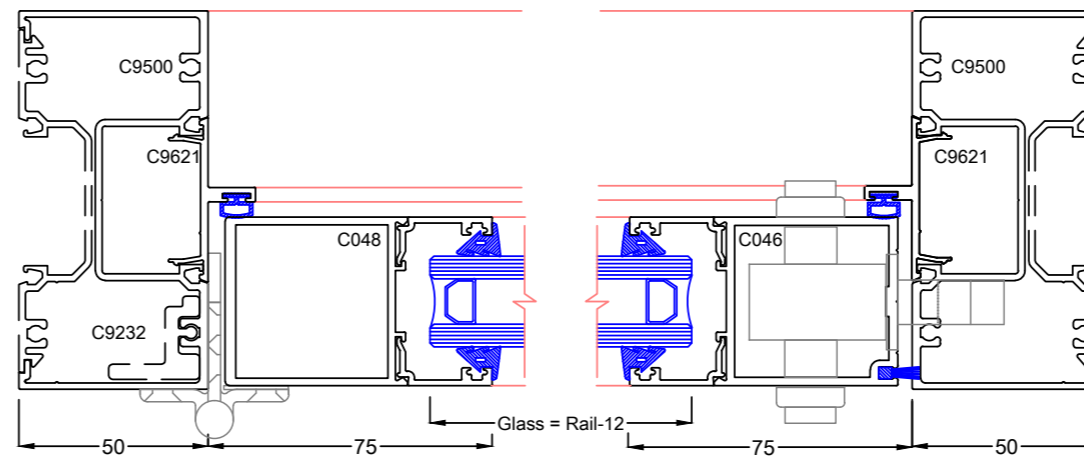

Left Hand Open Out Door with Wide Plain & Lock Stile

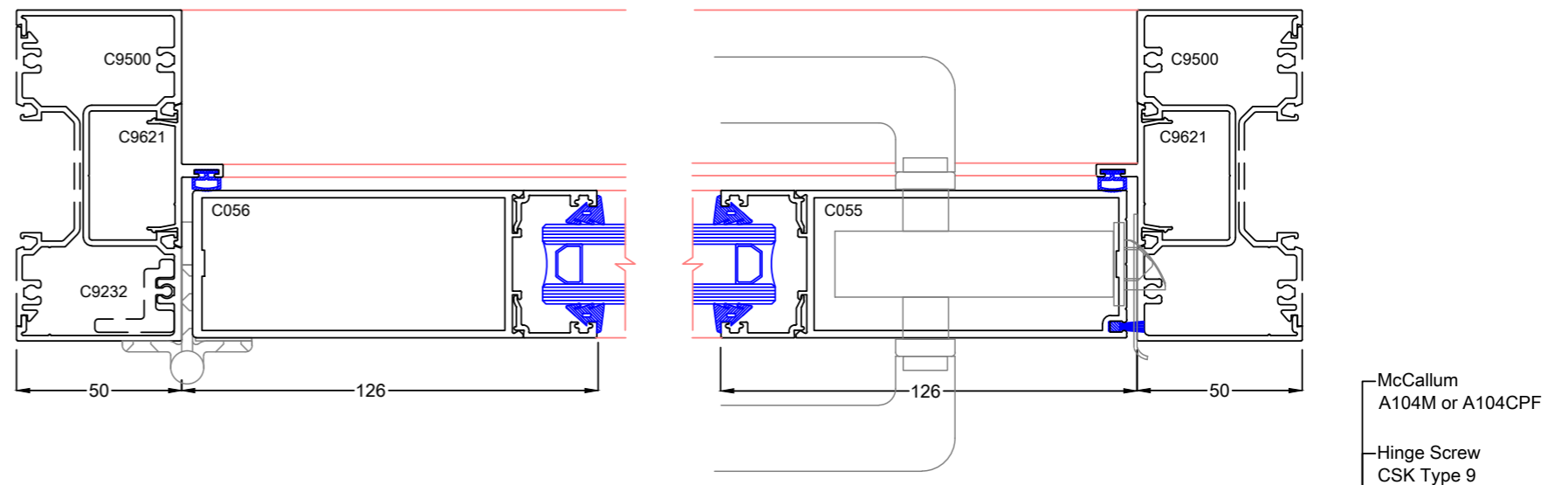

Pair of Open Out Hinged doors

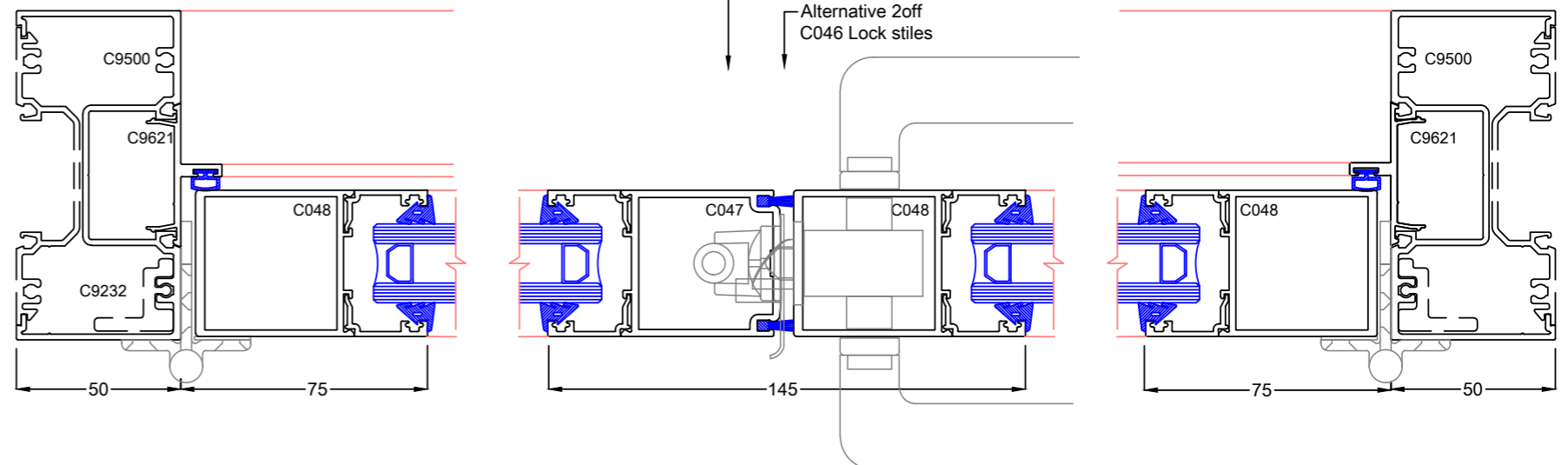

45mm BEADED DOOR
Max Doors - 1 - 5
Hinged Door Open IN

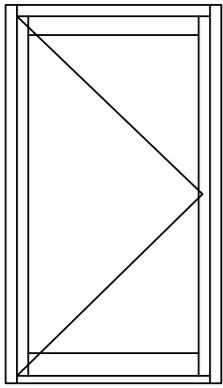

Note:
Maximum Door height 2700mm
Maximum Panel width 1000mm

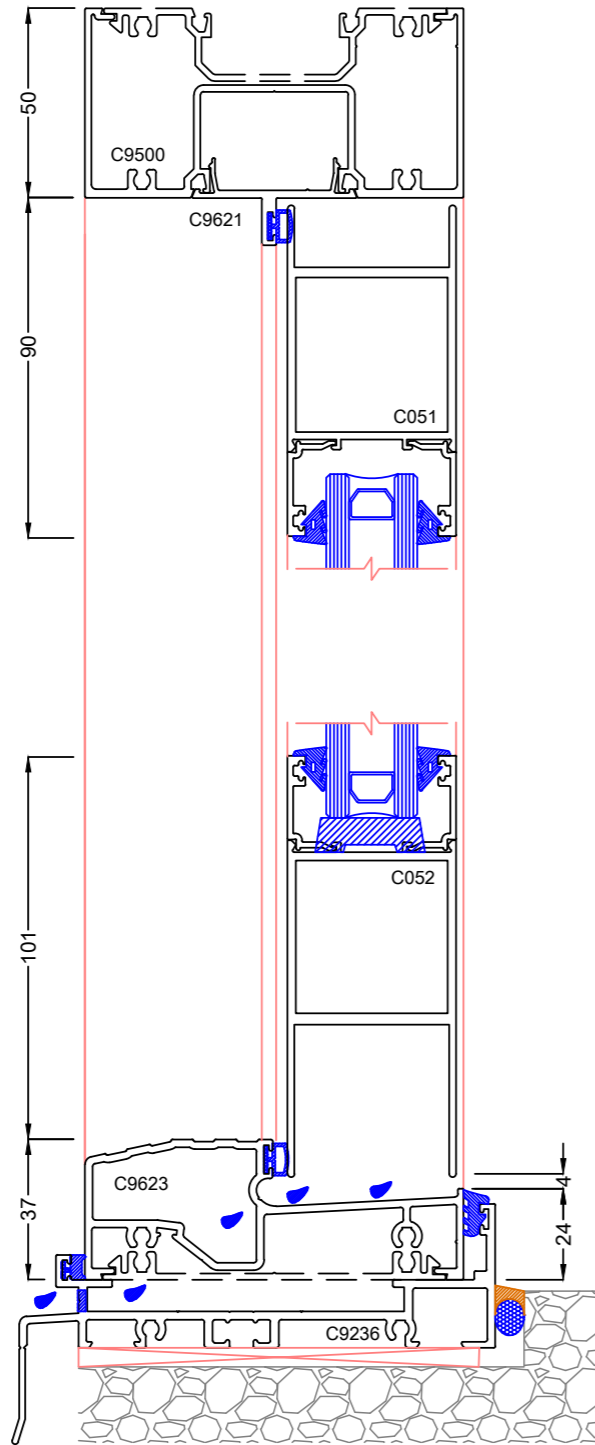

Left Hand Open In Door

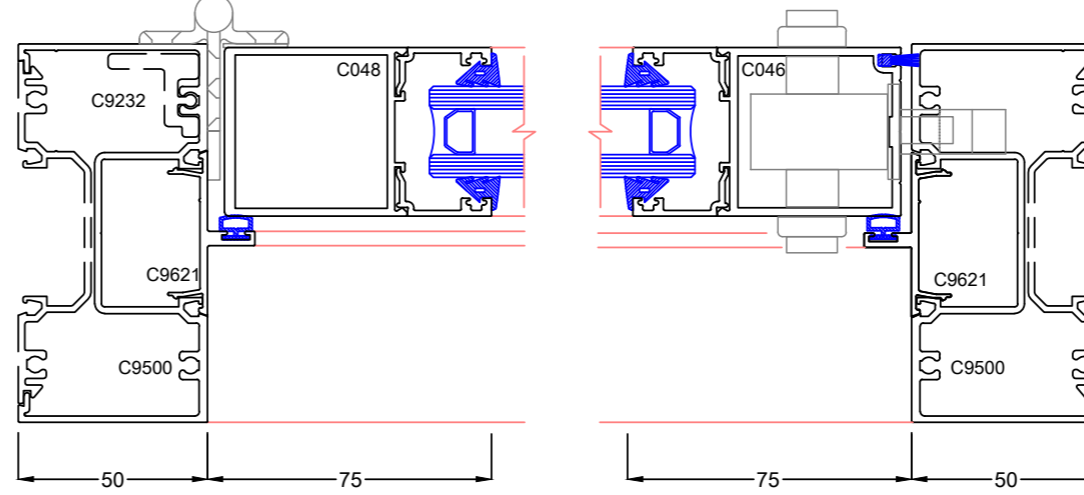

Left Hand Open in Door with Wide Plain & Lock Stile
Deep rails are usually used with wide stiles to accentuate the door leaf

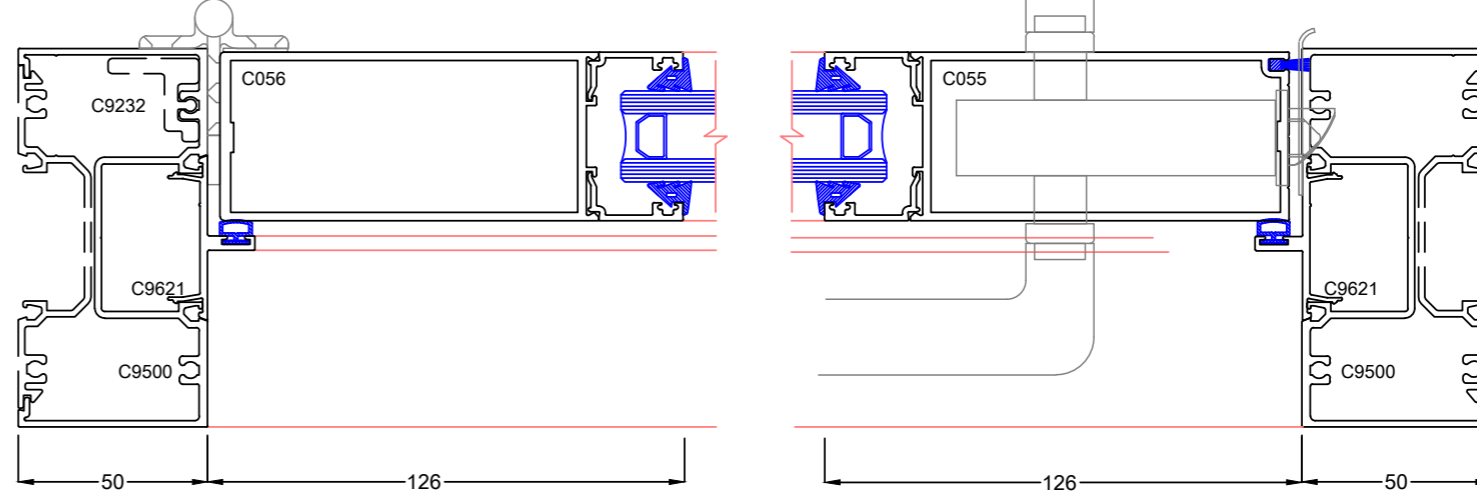

Pair of Open in Hinged doors

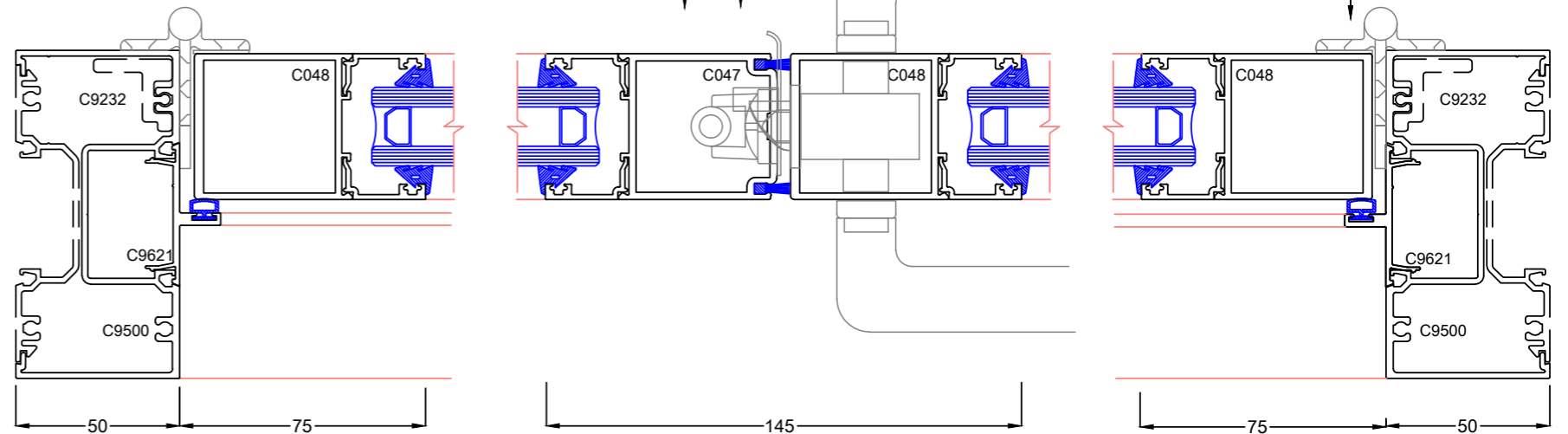

45mm BEADED DOOR
Max Doors - 1 - 6
Pivot Doors

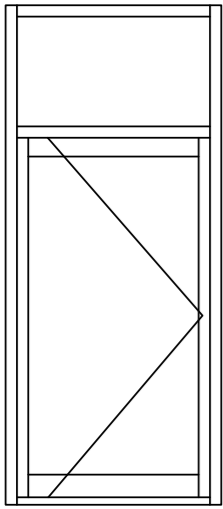

Note:
Maximum Door height 2700mm
Maximum Panel width 1000mm
Pivot point usually 100mm

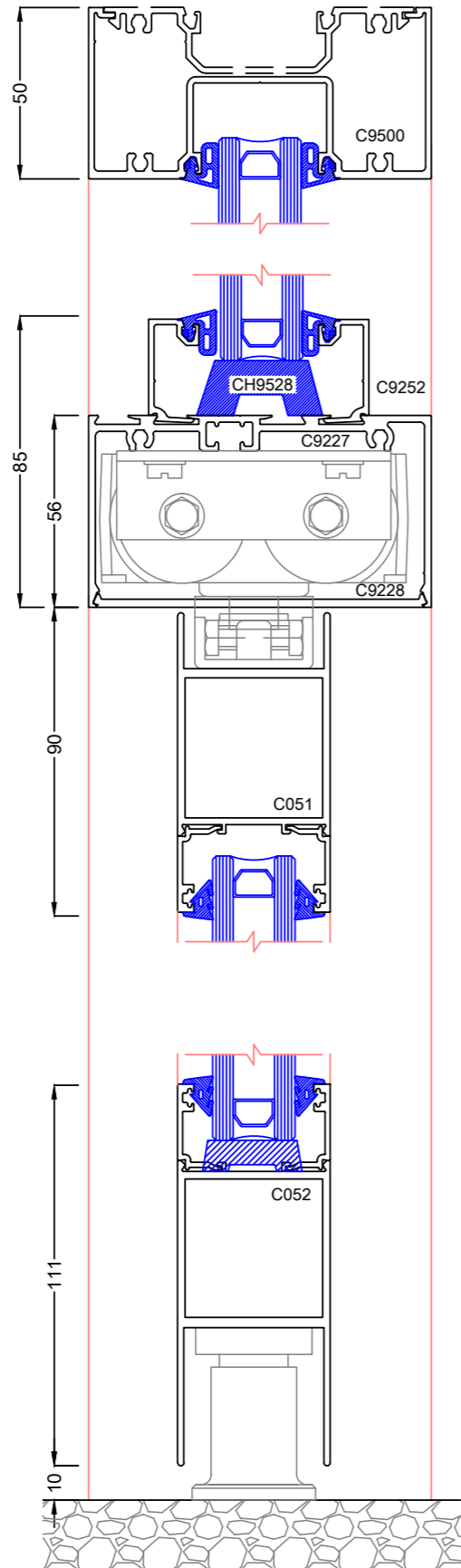

Left Hand Pivot Door

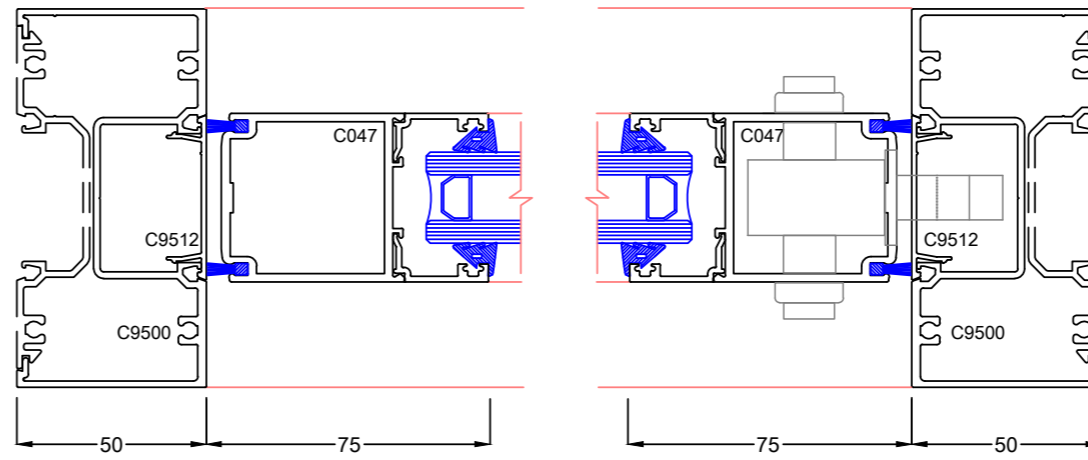

Left Hand Pivot Door with Wide Stiles
Deep rails are usually used with wide stiles to accentuate the door leaf

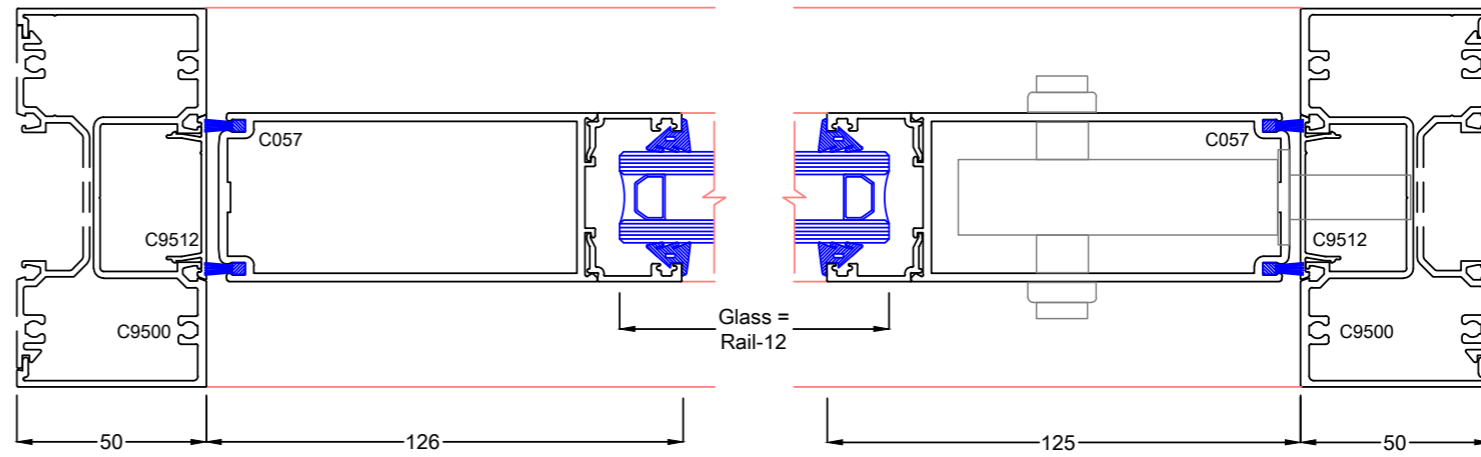

Pair of Pivot doors

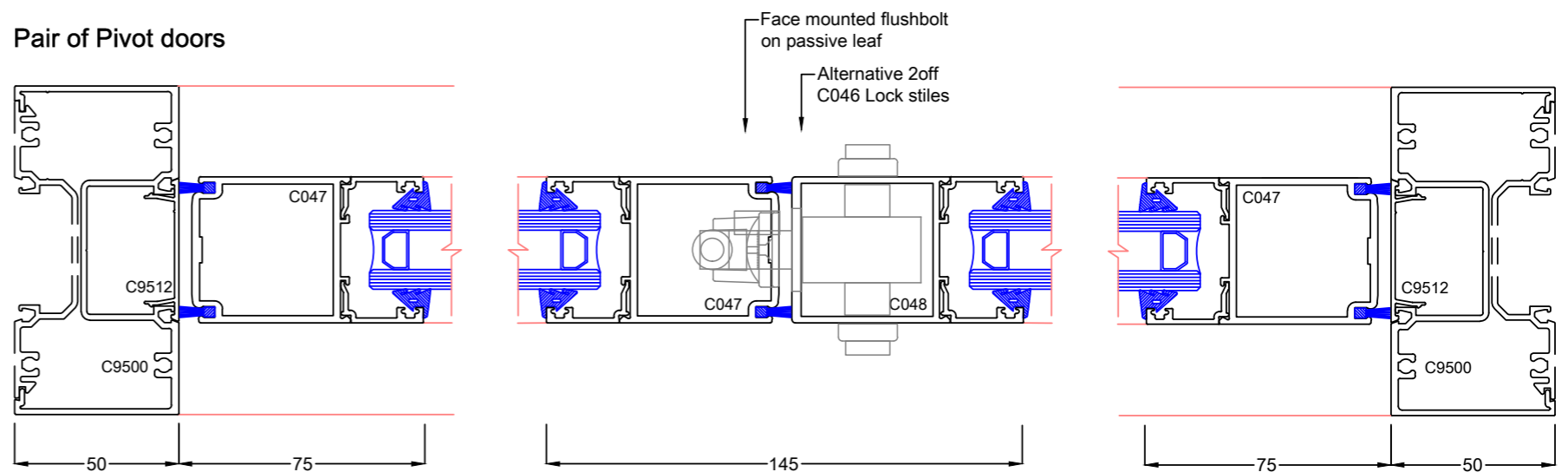

45mm BEADED DOOR

Max Doors - 1 - 7

Sliding Bottom Track - 300kg panel weight

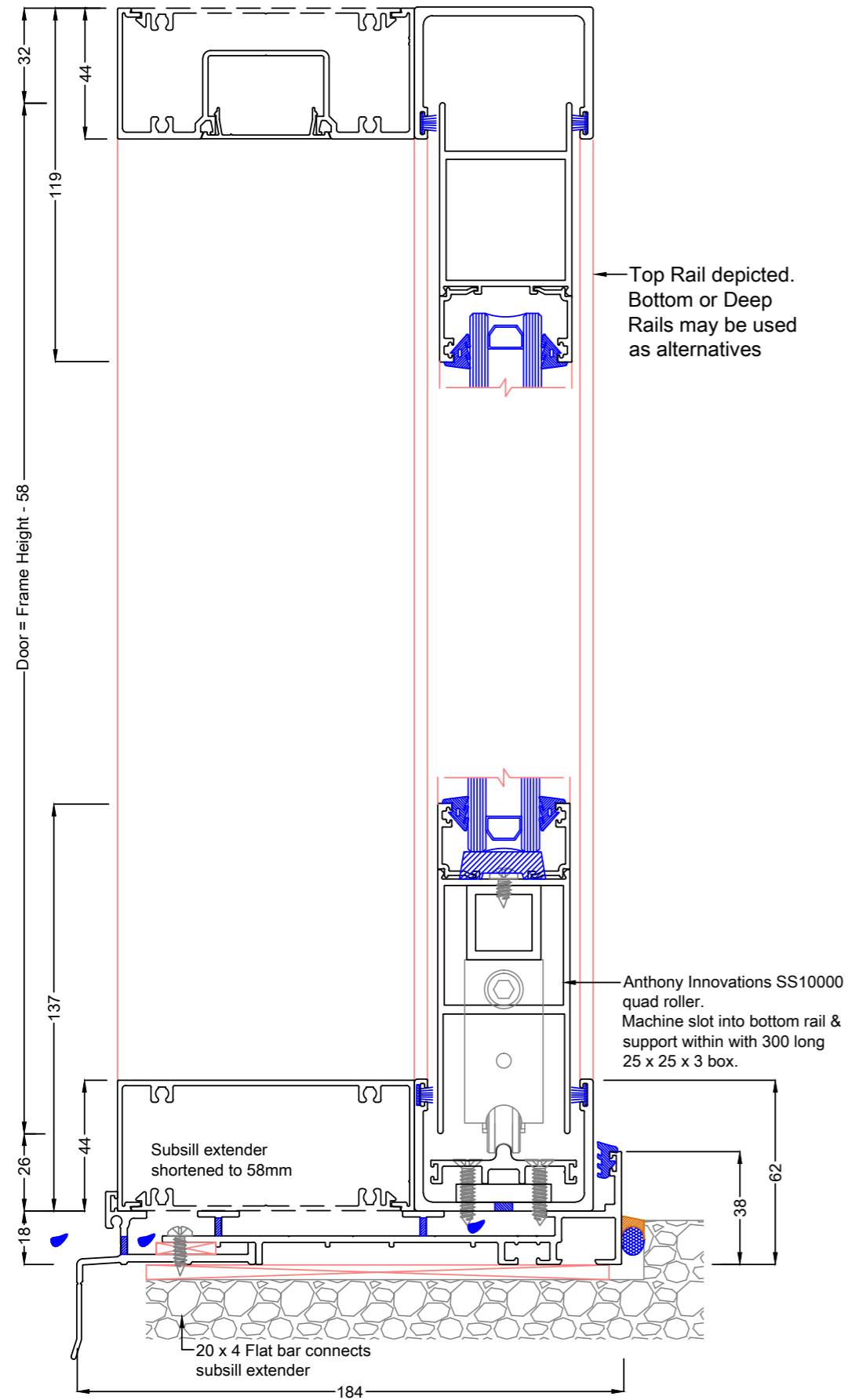

Top Rolling Track - 220kg Panel Weight

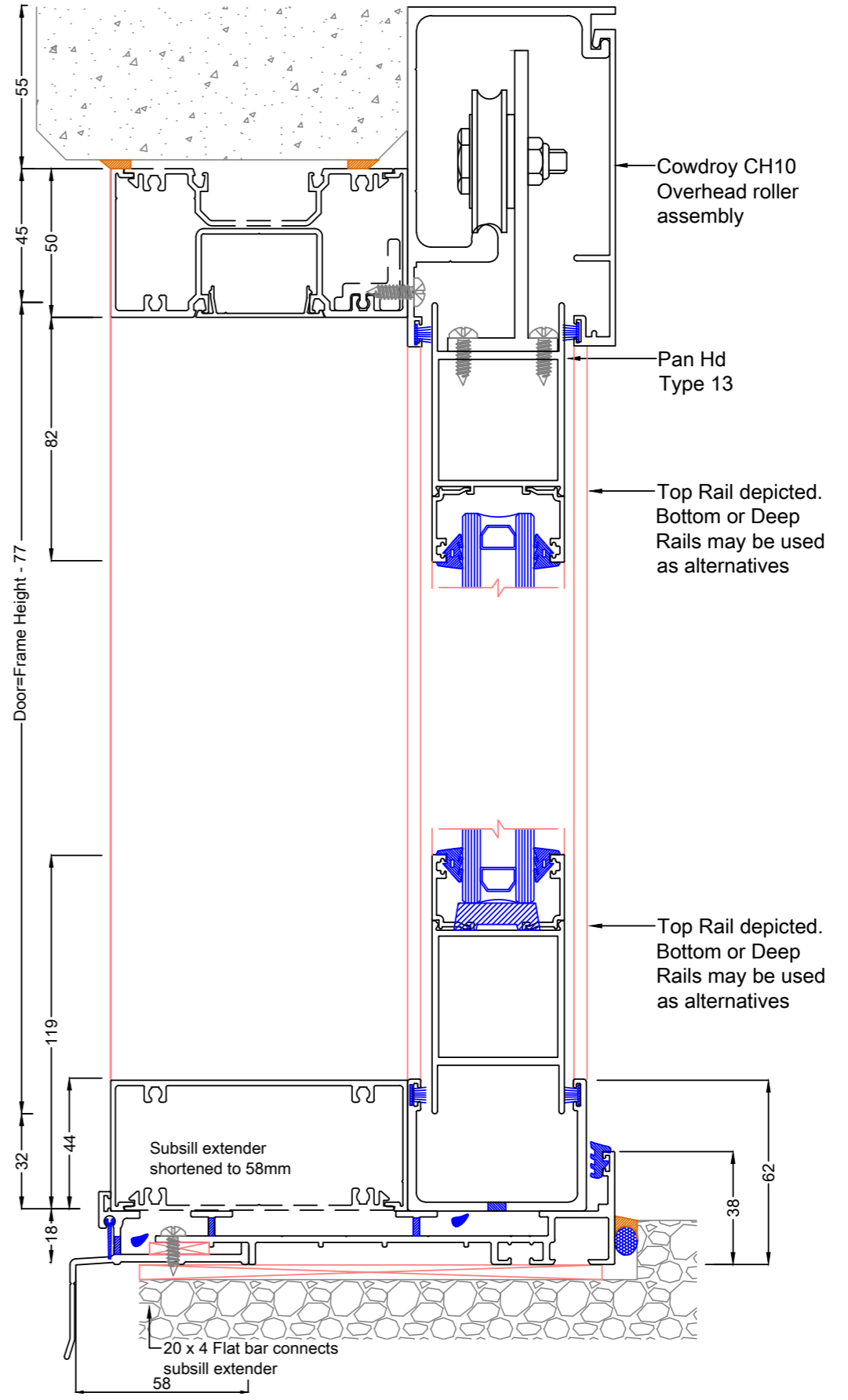

45mm BEADED DOOR

Max Doors - 1 - 8

Sliding Door with Closing Jamb in 100 Fixed framing

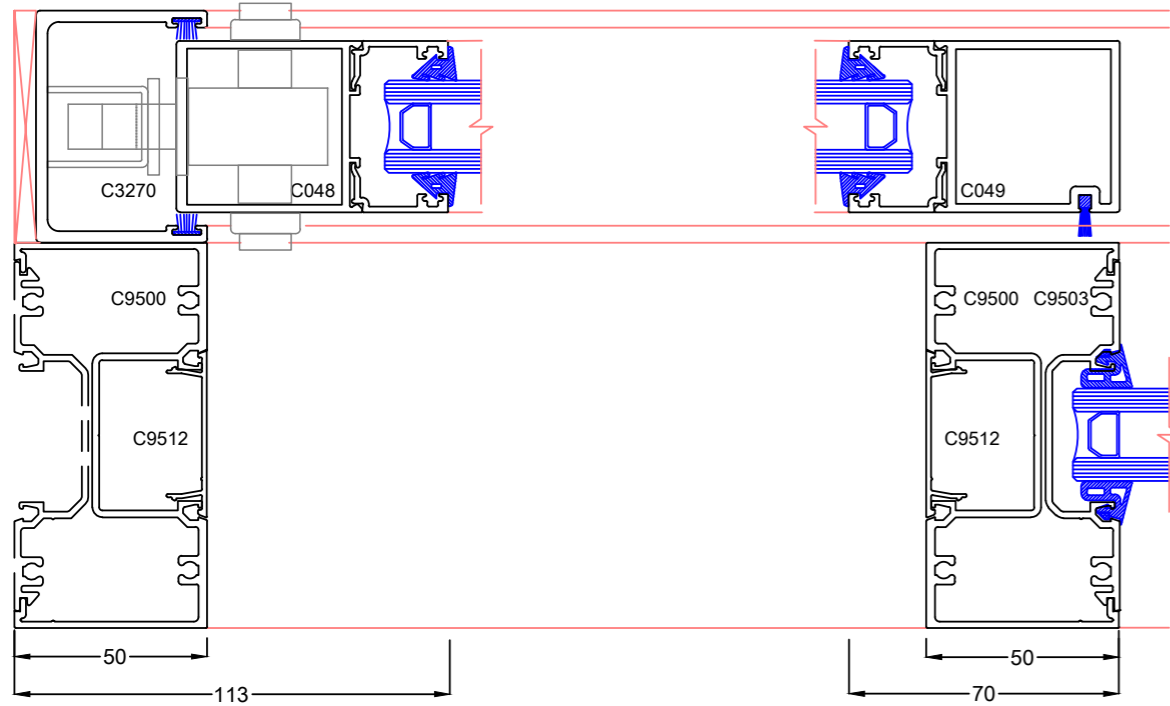

Sliding Door with Closing Jamb in 100 Front Glazed Fixed framing.
Alternative bead detail.

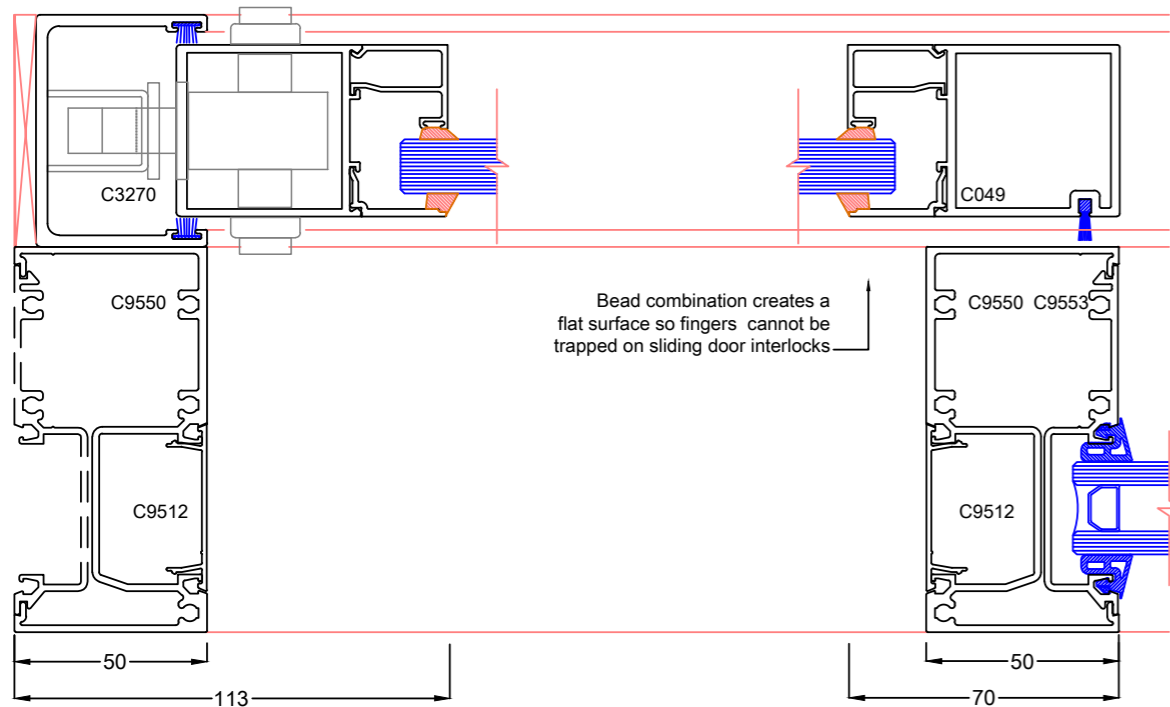

Top Hung Track 250kg

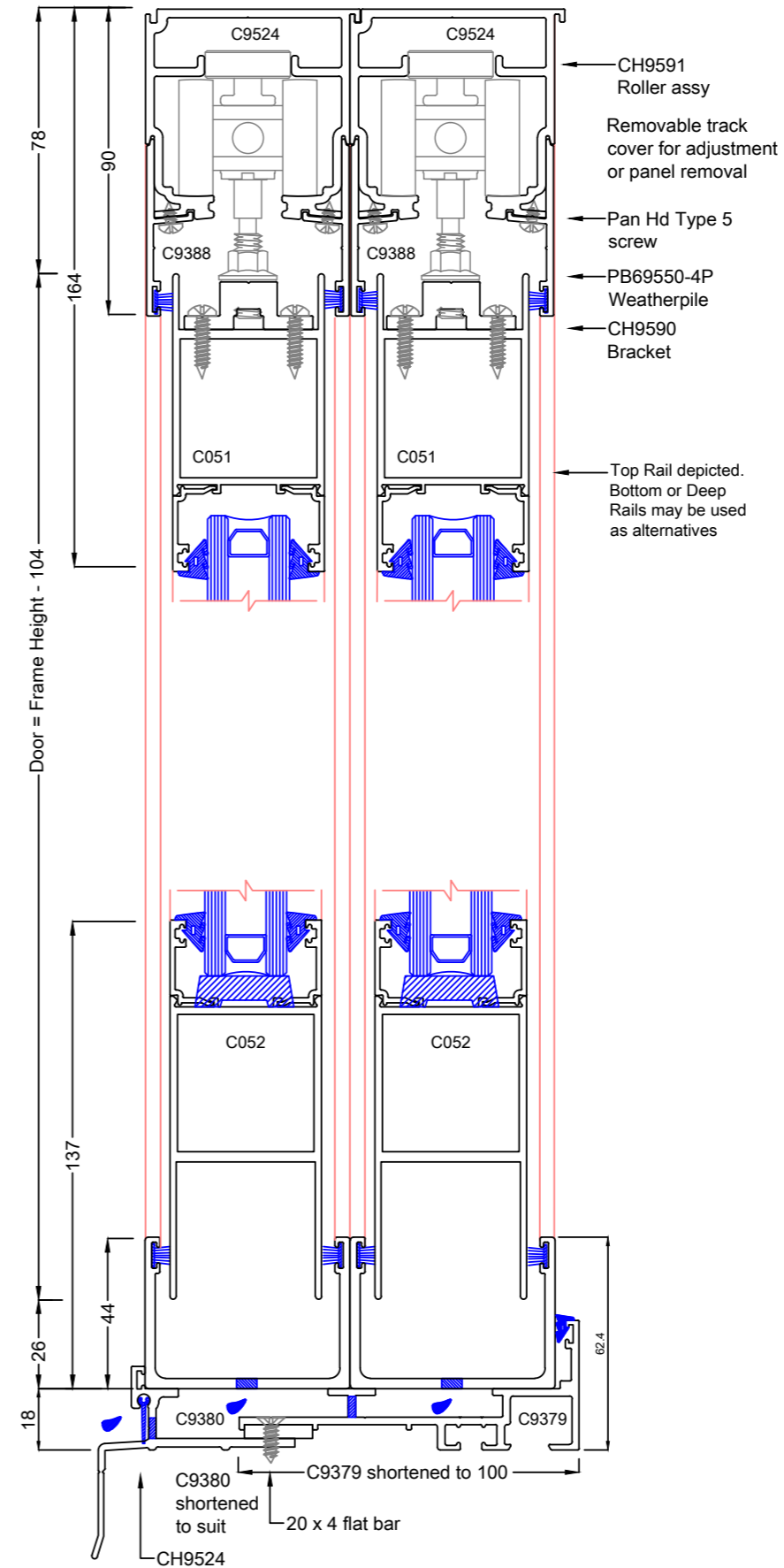

Bottom Sliding Track 250kg

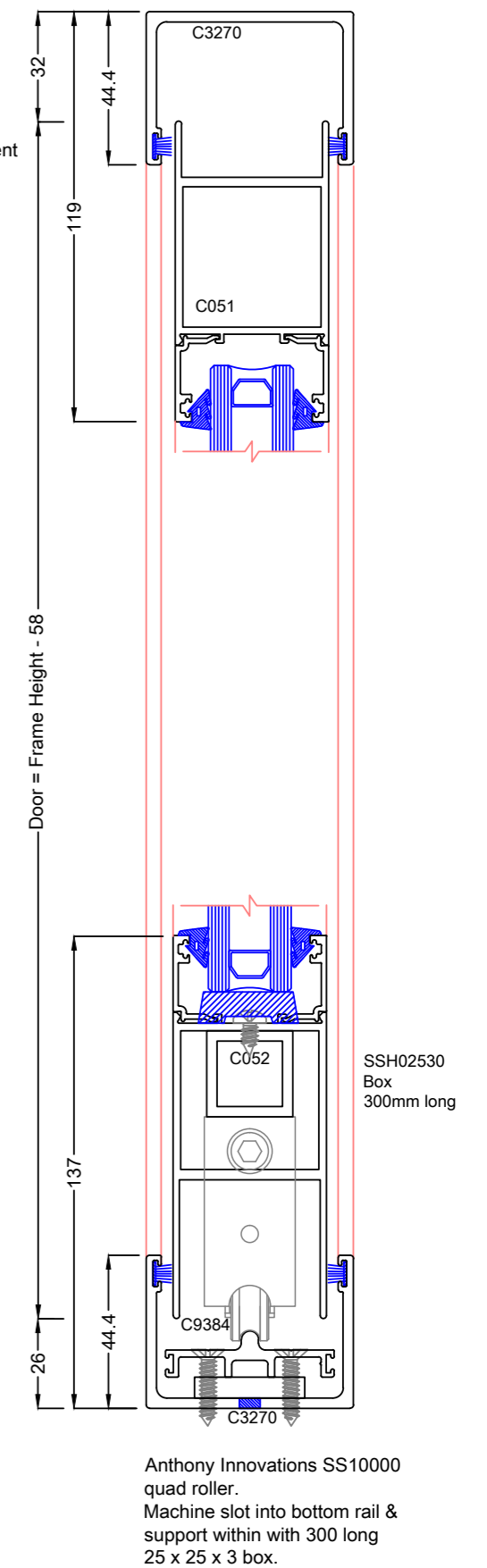

45mm BEADED DOOR
Max Doors - 1 - 9
Stacking Panels - Top or Bottom track

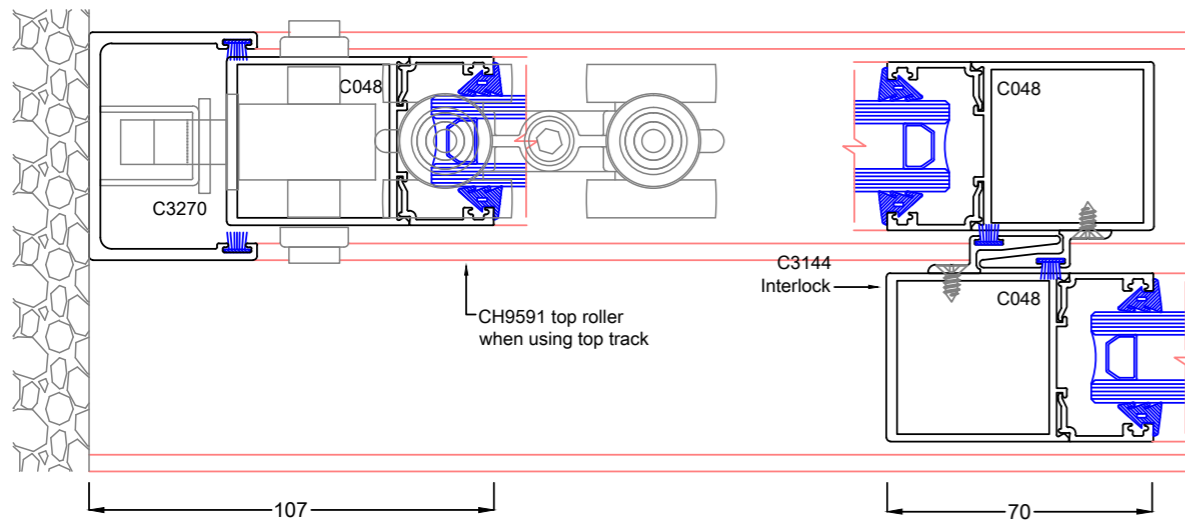

Door Midrail Options

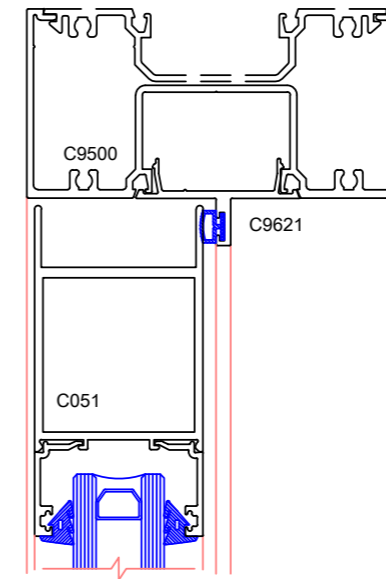

95mm Door Midrail

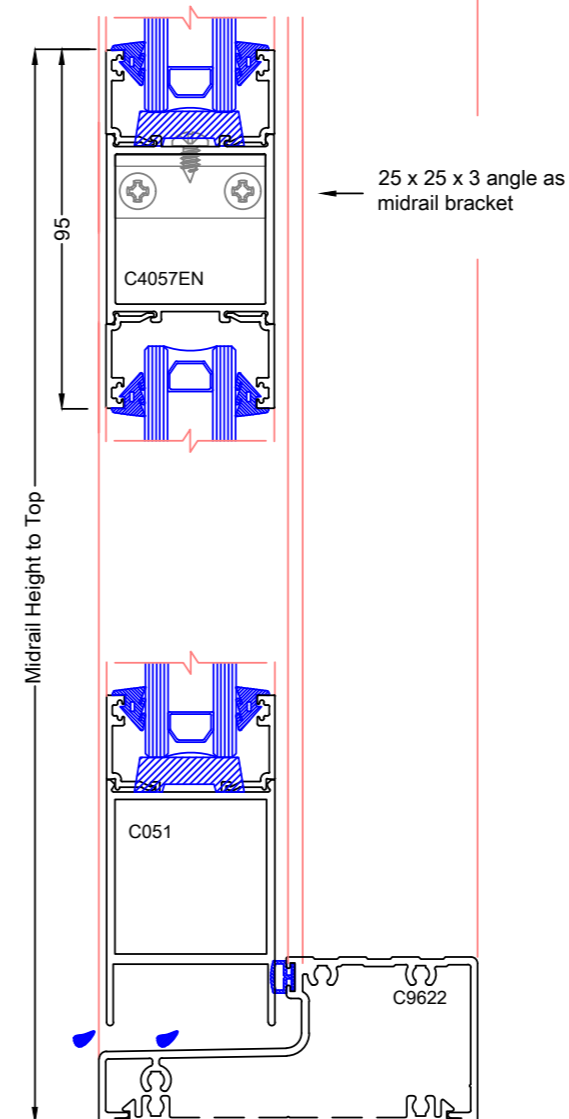

197mm Door Midrail

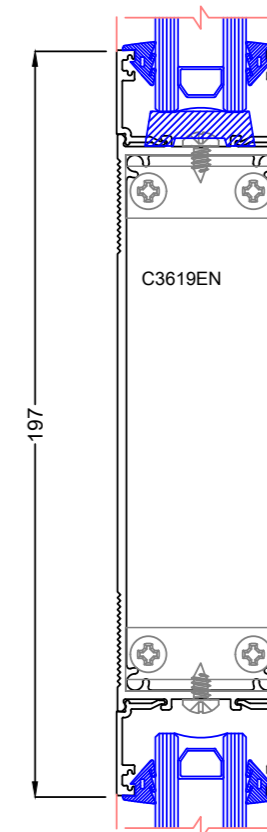

45mm BEADED DOOR

Max Doors - 1 - 10

Louvre Panels

Popularly used in plant rooms, Louvred panels are easily fitted within the 45mm door leaf.

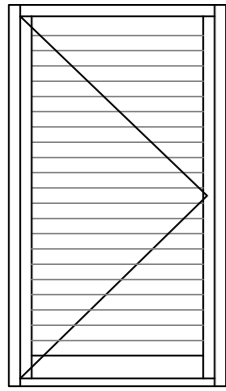

Note:
Maximum Door height 2700mm
Maximum Panel width 1000mm

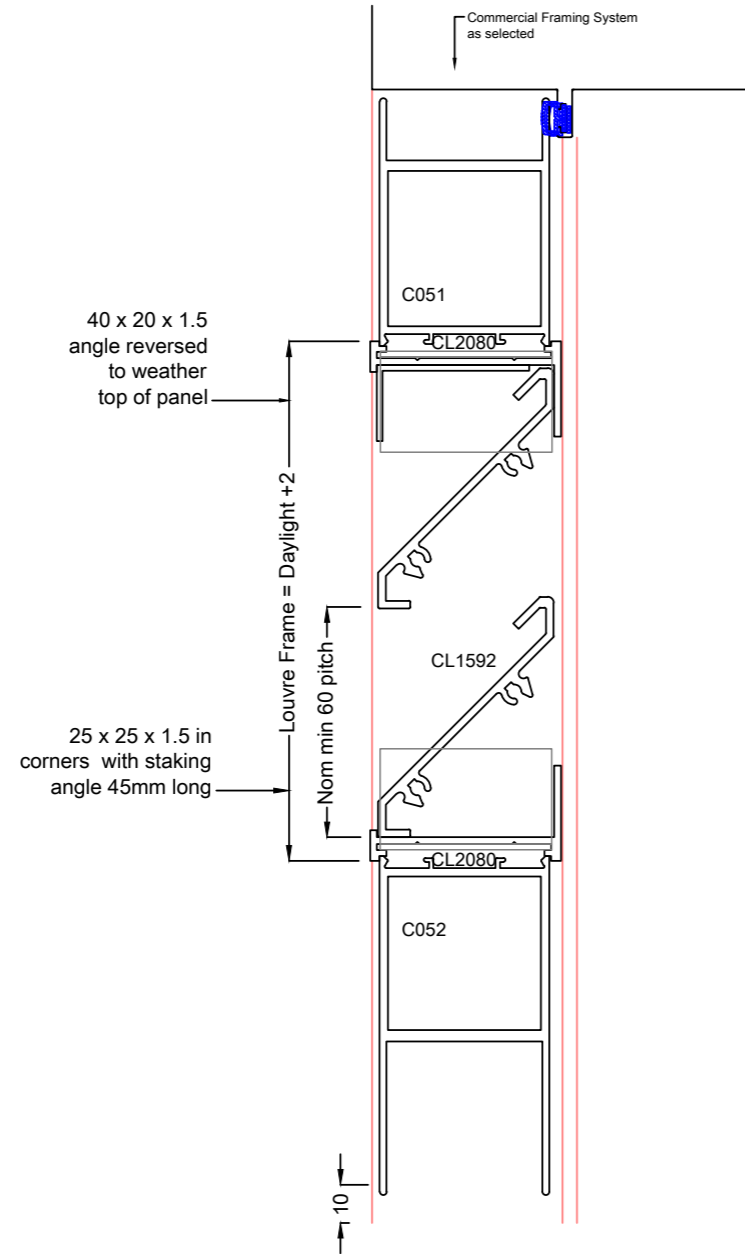

Louvre frame mitre cut and assembled with 45mm long 25 x 25 x 1.5 angle staked in corners.
Door leaf assembled around Louvre panel.

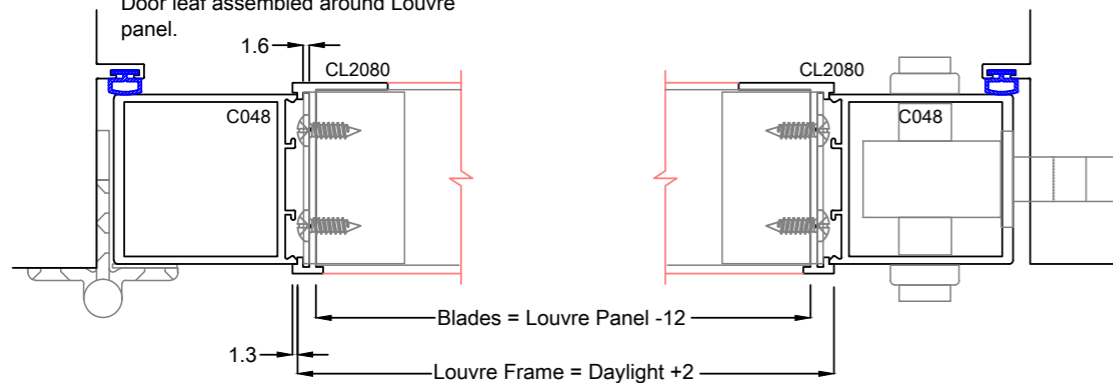

Glazing Details

